



FINALLY ARRIVED IN BELDERSOY

Cradled in the heart of Uzbekistan's majestic Tian Shan Mountains, Beldersoy Resort & Spa, part of Destination by Hyatt is where silence meets soul. At 1,600 meters above sea level, this alpine retreat blends the thrill of adventure with the serenity of wellness. Here, the rhythm of nature defines each moment — from powder-white mornings to golden sunsets over the peaks. Just 90 minutes from Tashkent, Beldersoy welcomes guests to rediscover balance, beauty, and belonging — a place where you've truly Finally Arrived.



ACCOMMODATION

148 Rooms And Villas designed for harmony between alpine nature and modern sophistication.

Hotel (109 room) including

- 91 King & Twin High Floor Rooms (1 Accessible Room) – 31 sq m | Mountain or valley views

- 8 Junior Suite & 4 Junior Suite Deluxe – 49-58 sq m |

Open-plan living

- 4 Osmon Suites – 100 sq m | Refined mountain elegance
- 1 Presidential Suite – 300 sq m | The pinnacle of privacy

Villas (39)

- 20 Two Bedroom Villas (100 sqm)
- 5 Two Bedroom Villas Mountain view (100 sqm)
- 4 Two Bedroom Villas Deluxe (157sqm)
- 1 Two Bedroom Villa Premium (202 sqm)
- 5 Three Bedroom Villas (153sqm)
- 2 Three Bedroom Villas Deluxe (202 sqm)
- 2 Four Bedroom Villas (208 sqm)

All Accommodations Offer:

- Wireless high-speed internet access
- Television with remote control, cable movie channels, in-room pay movies, closed captioning, and Web TV
- Climate control
- Electronic door lock
- Full / deluxe bath amenities and hair dryer
- Coffeemaker
- Iron / ironing board
- Workstation includes a large work desk with chair



DINING & LOUNGES

A culinary journey inspired by mountain purity and local authenticity:

FIRE & ICE

Fire & Ice is a premium steakhouse and vodka bar offering flame-grilled meats, crafted beverages, and a high-energy evening atmosphere.

SOMA

SOMA is the hotel's luxury Mediterranean fine-dining restaurant, focused on refined cuisine, wine service, and an intimate evening dining experience.

MONTIS

Montis is a panoramic restaurant serving turkish and uzbek cuisine for guests dining while enjoying mountain views.

- NAFIS
NAFIS is the hotel's main all-day restaurant, serving international cuisine in an elegant and relaxed setting for lunch and dinner.
- LOBBY LOUNGE



RE: THALASSO SPA & WELLNESS

Inspired by the healing power of water.

- THERMAL ZONE:**
Hammam, saunas, aroma and salt steam rooms, Kneipp baths
- POOLS:**
Indoor/outdoor, seawater, floating magnesium, infinity pool
- TREATMENTS:**
Thalassotherapy, facials, detox, and signature rituals
- COUPLES SUITES & RETAIL BOUTIQUE



MEETINGS & EVENTS

- TIAN SHAN BALLROOM:**
470 sq m, up to 500 guests, divisible
 - BOARDROOMS:**
two 45 sq m intimate spaces
- State-of-the-art AV, customizable layouts, natural light



FAMILY EXPERIENCES

Beldersoy Kid's Club:

- Professionally Designed Safe & Fun Zone
- Indoor & Outdoor Play, Supervised Activities,
- Seasonal Programs



CLIMATE & SEASONS

Season Temperature Highlights

- WINTER (DEC-MAR):**
-10°C to +8°C | Skiing, snowboarding, cozy après-ski
- SPRING (APR-MAY):**
10°C to 20°C | Blooming valleys, spa escapes
- SUMMER (JUN-AUG):**
15°C to 28°C | Hiking, alpine coaster, zipline
- AUTUMN (SEP-NOV):**
5°C to 18°C | Golden landscapes, crisp air



SPORTS & FITNESS

- 150 sq m Fully Equipped Indoor Gym
- Squash Court, Yoga Decks, Group Training Studio



WINTER EXPERIENCES

- 3.5 Km Ski Trail With Varying Gradients
- Ski School With Certified Instructors & Rentals
- Snow Tubing Zone – Family-friendly Fun



SUMMER & YEAR-ROUND ACTIVITIES

- ALPINE COASTER (RODELBAHN):**
- thrilling gravity-powered ride
- 500M ZIPLINE:**
- adrenaline flight across forested slopes
- GONDOLAS & ROPEWAYS:**
- panoramic access to mountains year-round



TASHKENT - ISTANBUL 5 HOURS
TASHKENT - ALMATY 1.5 HOURS
TASHKENT - ASTANA 3.5 HOURS
TASHKENT - BAKU 2.5 HOURS

TASHKENT - DUBAI 4 HOURS
TASHKENT - BEIJING 5 HOURS
TASHKENT - MOSCOW 3.5 HOURS



MEETINGS & CELEBRATIONS

TIAN SHAN BALLROOM
470 sq m, up to 500 guests

BOARDROOMS (2)
45 sq m each

Natural light, mountain views, and flexible configurations for corporate and private events.

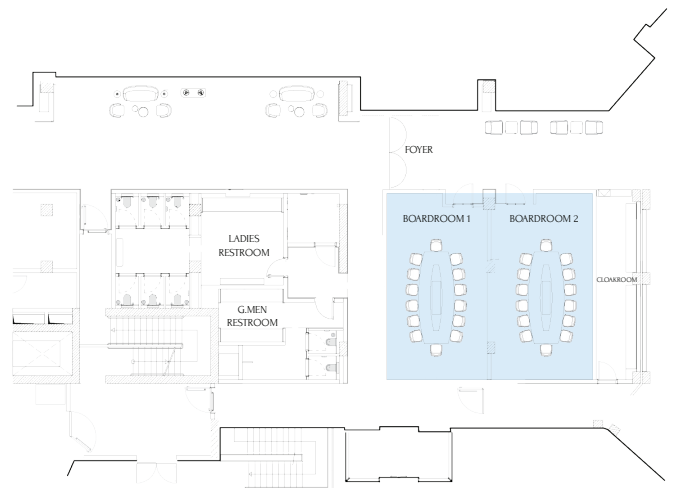
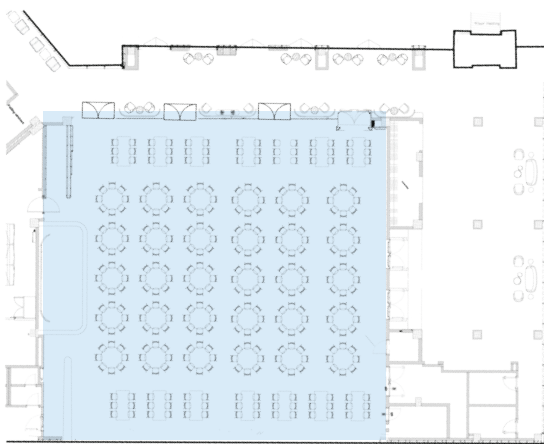

VENUE	AREA (SQ.M)	BOARDROOM	U SHAPE	CLASSROOM	THEATER	BANQUET (ROUNDS)	RECEPTION COCKTAIL
MEETING SPACES							
TIAN SHAN BALLROOM	470	80	100	240	450	280	500
TIAN MEETING ROOM	230	50	60	120	200	120	200
SHAN MEETING ROOM	230	50	60	120	200	120	200
BOARDROOM 1	45	14	12	-	-	-	-
BOARDROOM 2	45	14	12	-	-	-	-